

# Alfred Nobel Hall

The spacious Alfred Nobel Hall can be used for exhibitions, receptions, seminars and meetings. It boasts state-of-the-art audio and visual equipment, and its excellent acoustics make it a choice space for concerts. A removable stage is available and comes in different sizes and configurations. The hall can be subdivided into two separate spaces, which can be used either individually or together.

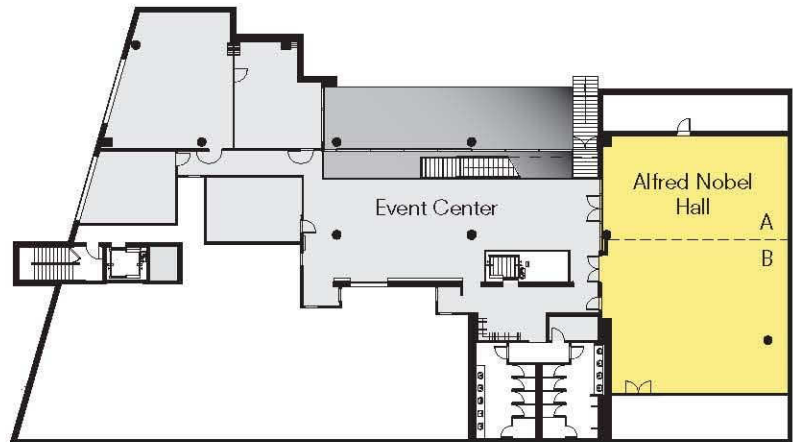

## Meeting capacities

Room	Dimensions (ft.)	Size		Ht. (ft.)	Capacities				
		(sq.ft.)	(sq.m.)		Banquet	Theater	Conference	Reception	Classroom
Alfred Nobel Hall	44x61	2670	248	9'-0"	180 pers	180 pers	140 pers	180 pers	120 pers
A	44x24	1050	102	9'-0"	60	80	60	80	50 pers
B	44x37	1620	146	9'-0"	100	120	80	120	70 pers

Theater seating  
- See opposite page for alternative layouts

